

**LEGEND:**

**WATER QUALITY MONITORING STATIONS**

- C1 HONG KONG CONVENTION AND EXHIBITION CENTRE EXTENSION
- C2 TELECOM HOUSE/HK ACADEMY FOR PERFORMING/ SHUI ON CENTRE
- C3 HONG KONG CONVENTION AND EXHIBITION CENTRE PHASE I
- C4 WAN CHAI TOWER AND GREAT EAGLE CENTRE
- C5 SUN HUNG KAI CENTRE
- C6 PROPOSED EXHIBITION STATION / WORLD TRADE CENTRE
- C7 WINDSOR HOUSE
- C8 CITY GARDEN
- C9 PROVIDENT CENTRE
- RC1 PROPOSED HKAPA EXTENSION
- RC5 SUN HUNG KAI CENTRE (REPROVISION)
- RC7 WINDSOR HOUSE (TEMPORARY REPROVISION)
- WSD21 WAN CHAI
- RW1 WAN CHAI (REPROVISION)

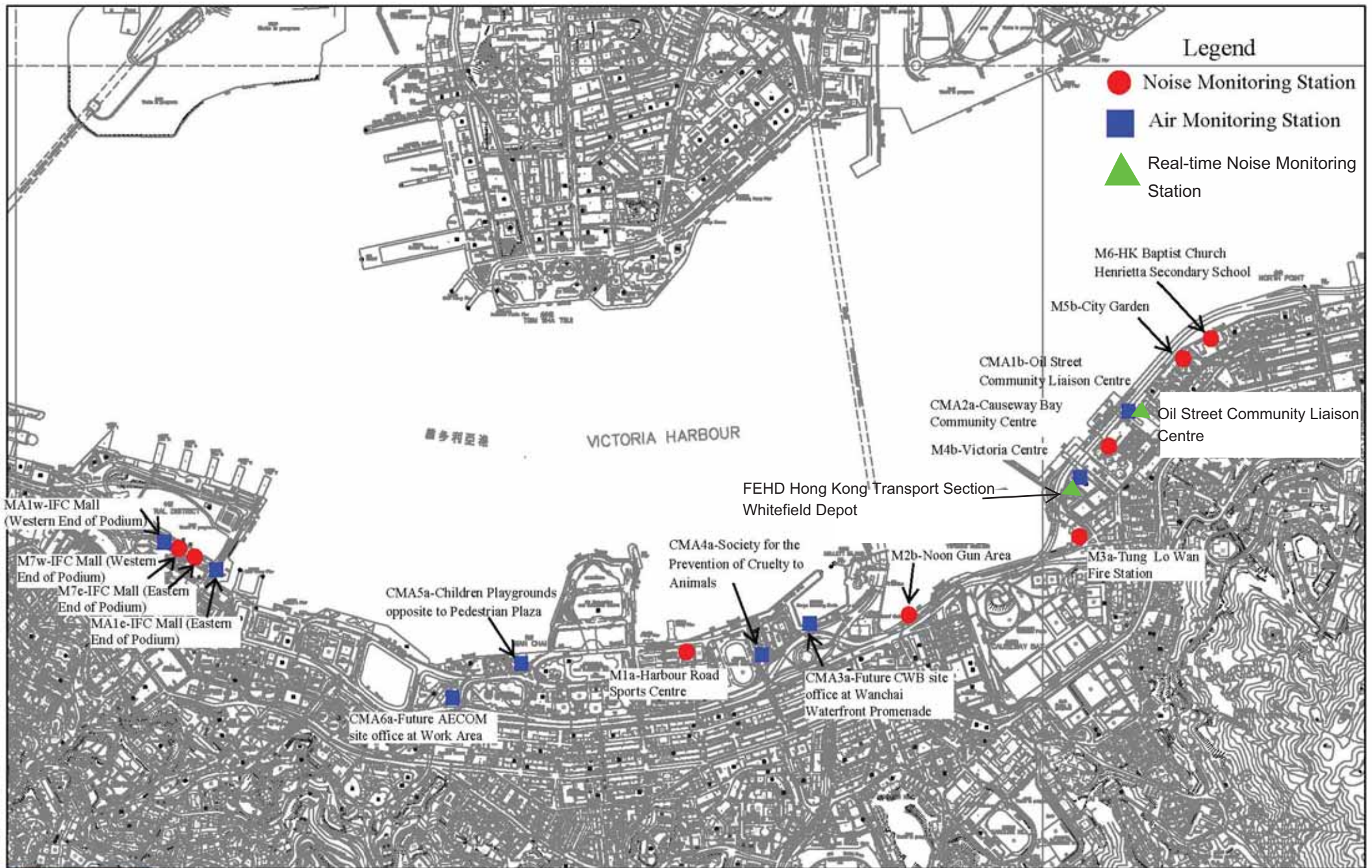





C6 AND C7: EXISTING SEAWATER INTAKE

----- : ODOR PATROL ROUTES FOR CONSTRUCTION PHASE

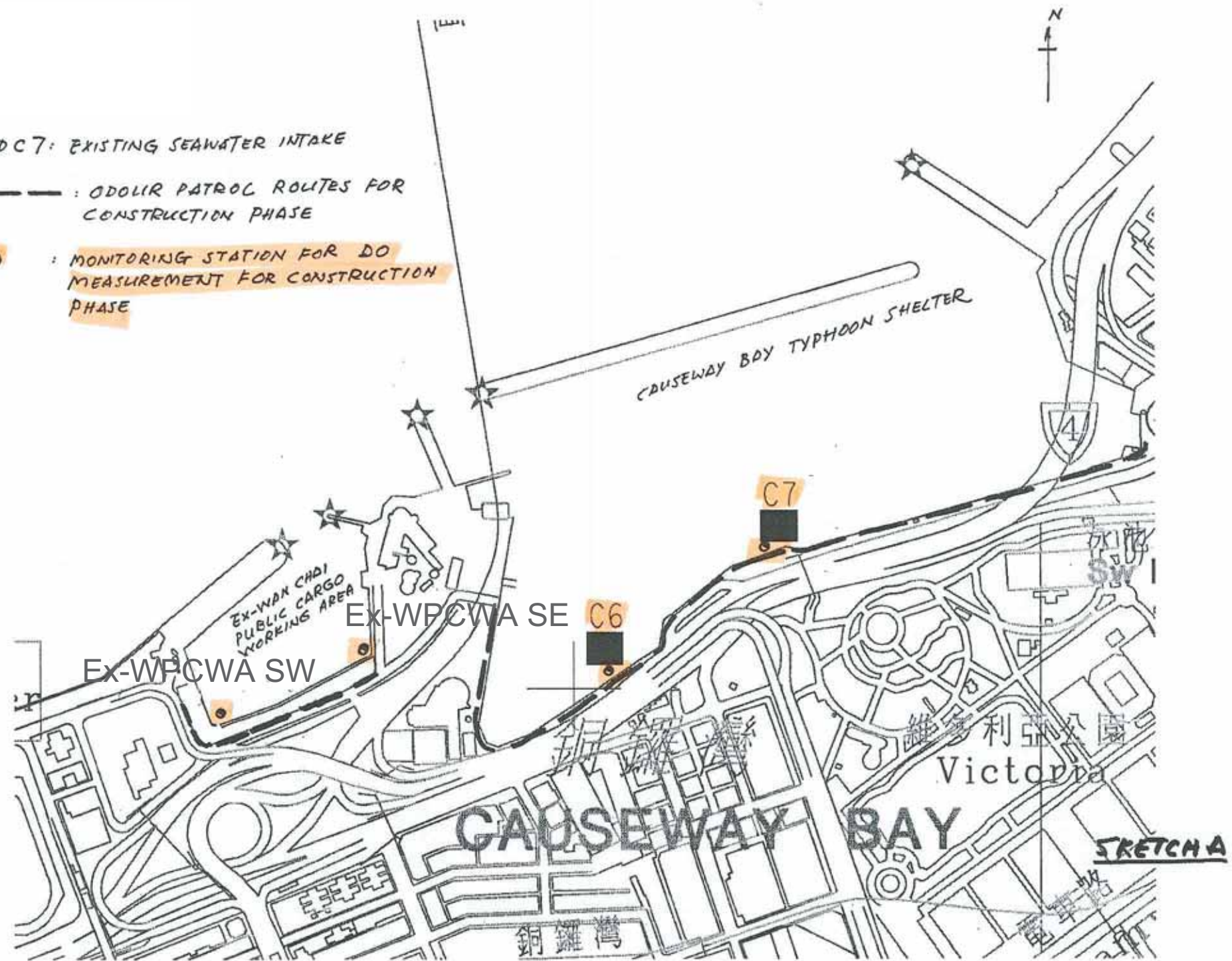
● : MONITORING STATION FOR DO MEASUREMENT FOR CONSTRUCTION PHASE



C6 AND C7: EXISTING SEAWATER INTAKE

 : ODOR PATROL ROUTES FOR CONSTRUCTION PHASE

 : MONITORING STATION FOR DO MEASUREMENT FOR CONSTRUCTION PHASE

 Odour Patrol Location

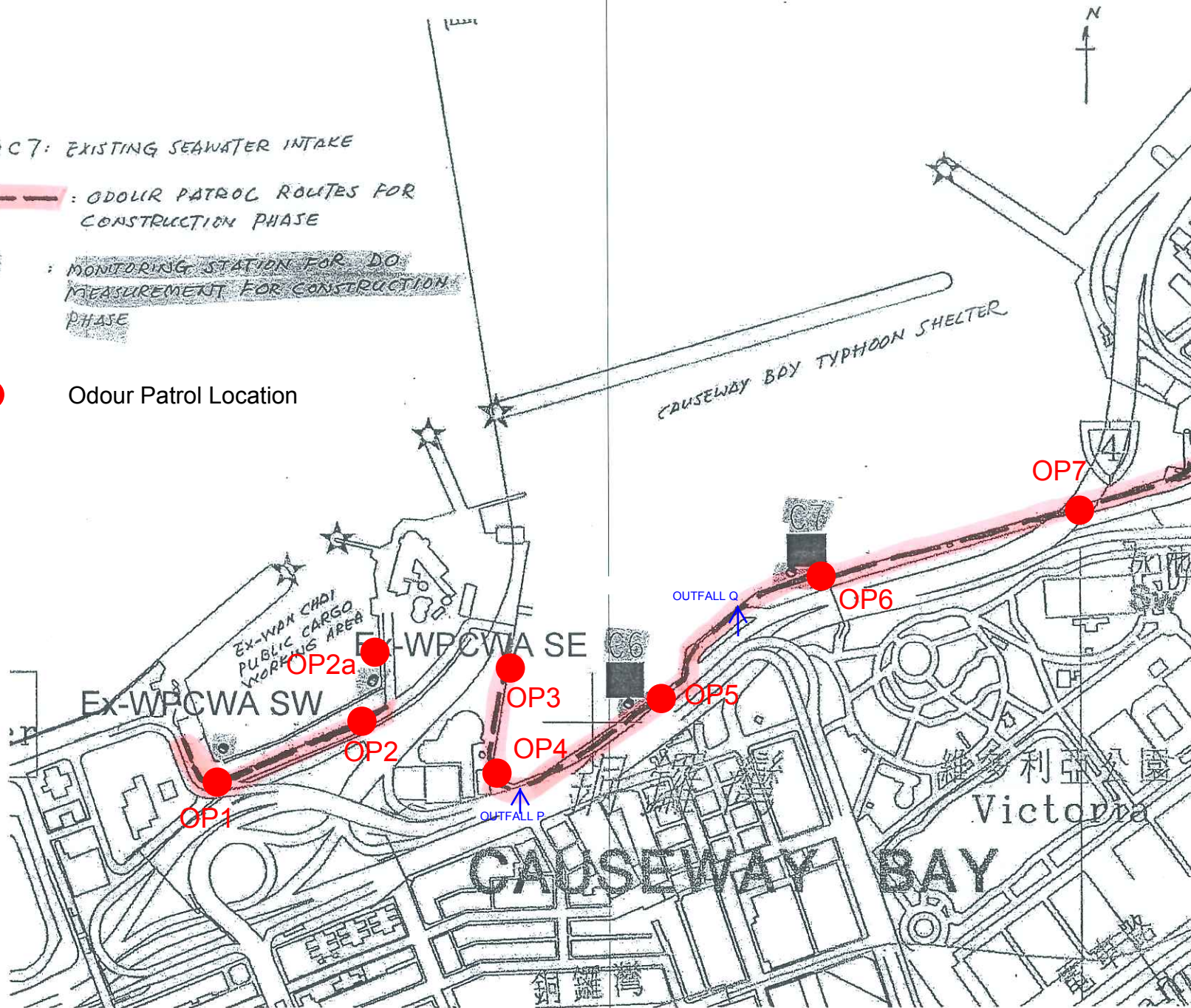

中環填海計劃  
第三期邊界  
CR III  
LIMIT

灣仔發展計劃  
第二期區域  
WDII REVIEW  
STUDY AREA



**Embayment Area**



**Additional DO Monitoring Station**

( A: 835468E, 815857N

B: 835572E, 815961N

C: 835659E, 816271N)

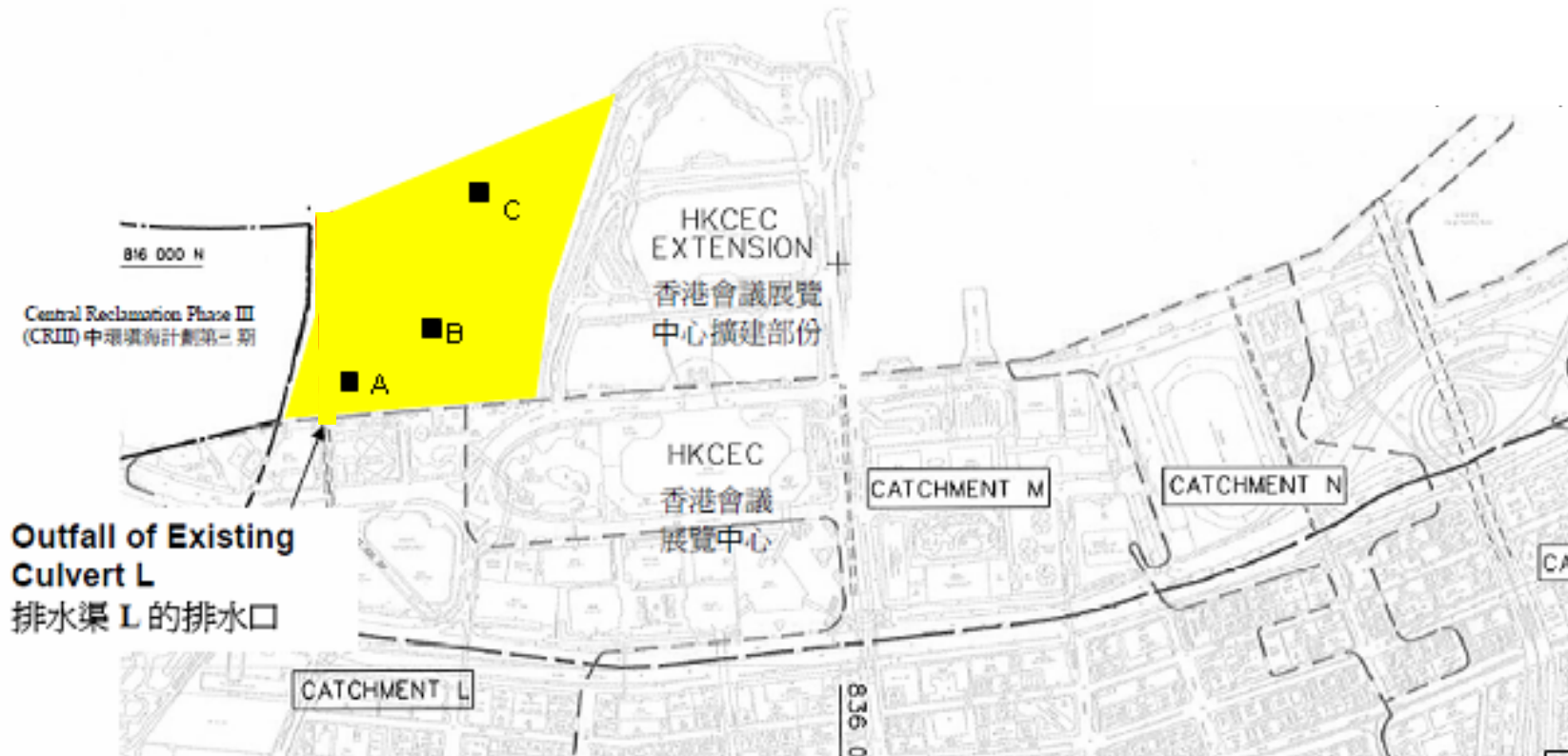

NOT IN SCALE



Location Plan of Additional Dissolved Oxygen Monitoring Stations  
for Culvert L Water Discharge Flow